

Date: 15/04/2016

Ref: 1314951

LICENSING DEPARTMENT  
Bolton Metropolitan Borough Council  
Town Hall  
Bolton  
Lancashire  
BL1 1RU

Sent to PAC + UG with copy  
of consent letter

Dear Sir/Madam,

Awaiting plan + reason

**RE: LICENSED PREMISES NOTIFICATION/GAMING MACHINE PERMIT**

I enclose herewith a Licensed Premises Notification/LPGMP application for the following site:

Red Lion  
1-3 Salford Road  
Over Hulton  
BL5 1BJ

The relevant fee is also enclosed and I would be obliged if you could forward the acknowledgement or permit to Gamestec for my attention at the address below when this has been granted.

The details will be noted on our records and a copy will be forwarded to the site. A prepaid envelope is enclosed for your convenience.

Thank you in anticipation of your assistance.

Yours faithfully



**Roz Sage**  
Licensing Department  
Gamestec Leisure Ltd  
[licensing@gamestec.co.uk](mailto:licensing@gamestec.co.uk)  
Enc.  
1314951



**Gamestec Leisure Limited**

B10 • Wira House • Wira Business Park • Ring Road • Leeds • LS16 6EB • Tel: 0113 258 9495 • Fax: 0113 239 0072  
Email: [enquiries@gamestec.co.uk](mailto:enquiries@gamestec.co.uk) • [www.gamestec.co.uk](http://www.gamestec.co.uk)

Registered in England No. 5348584 Registered office: Asta House, 1 Kingsway, Bridgend Industrial Estate, Bridgend, CF31 3RY UK Registered in England

**GAMING MACHINE PERMIT APPLICATIONS FOR MORE THAN 2 MACHINES:  
CONVERSION / NEW / VARIATION / TRANSFER**

(FOR USE BY PREMISES LICENSED TO SUPPLY ALCOHOL FOR CONSUMPTION ON THE PREMISES)

*Please refer to guidance notes at the back of this form before completing*

To: Bolton Metropolitan Borough Council  
Town Hall , , Bolton , Lancashire , BL1 1RU

**SECTION A – What do you want to do?**

1. Please indicate what you would like to do

a) Apply **to convert** an existing Section 34 permit issued under the Gaming Act 1968, into a licensed premises gaming machine permit where you want more than 2 gaming machines  
(if you choose this option then please complete sections B, D and E)

☐

b) Apply for a **new** licensed premises gaming machine permit where you want more than 2 gaming machines  
(if you choose this option then please complete sections B, D and E)

☐

c) Apply to **vary** an existing licensed premises gaming machine permit  
(if you choose this option then please complete sections B, D and E)

☒

d) Apply to **transfer** an existing licensed premises gaming machine permit  
(if you choose this option then please complete sections C, D and E)

☐

**SECTION B – Application for grant (includes conversion, new and variation applications)**

2. How many gaming machines are you currently authorised to provide and if this is a new or variation application, how many do you wish to provide? (please complete the boxes in the table)

Category machine	Number currently authorised to provide	Number wish to provide (new or variation)
C	4	4
D	0	2
Total:	4	6

3. If you are currently authorised to provide more than 2 machines, please provide your existing Section 34 Gaming Act 1968 permit, or provide reasons stating why it cannot be provided.

☐

Existing permit provided\*

(Reasons why existing permit cannot be provided)

.....

**\*Please keep a copy of your existing permit on the premises to which it relates.**

**GAMING MACHINE PERMIT APPLICATIONS FOR MORE THAN 2 MACHINES:  
CONVERSION / NEW / VARIATION / TRANSFER**

(FOR USE BY PREMISES LICENSED TO SUPPLY ALCOHOL FOR CONSUMPTION ON THE  
PREMISES)

<p><b>Section C – Application for permit <u>transfer</u></b> <i>(i.e. where a transfer has been requested for the Licensing Act 2003 premises licence)</i></p> <p>4. Name of person requesting the transfer</p> <p>.....</p> <p>5. Confirmation that an application to transfer the relevant Licensing Act 2003 Premises Licence has been:</p> <div style="text-align: right; margin-right: 20px;"><p>Requested <input type="checkbox"/></p><p>Granted <input type="checkbox"/></p></div> <p>6. Please provide your existing permit, or provide reasons stating why it cannot be provided</p> <div style="text-align: right; margin-right: 20px;"><p>Existing permit provided <input type="checkbox"/></p><p>Reasons why existing permit cannot be provided</p><p>.....</p></div>	
---	--

<p><b>Section D – General Information</b></p> <p>7. NAME OF PREMISES: Red Lion Fh</p> <p>8. ADDRESS OF PREMISES: 1-3 Salford Road , , , Over Hulton , BL5 1BJ</p> <p>9. TELEPHONE NUMBER OF PREMISES: UNKNOWN</p> <p>10. NAME OF EXISTING PREMISES LICENCE HOLDER: Spirit Pub Company Services Ltd</p> <p>11. ADDRESS OF PREMISES LICENCE HOLDER: Westgate Brewery, Bury St Edmunds, Suffolk, IP33 1QT</p> <p>12. DAYTIME TELEPHONE NUMBER OF PREMISES LICENCE HOLDER: 01284763222</p> <p>13. E-MAIL ADDRESS OF PREMISES LICENCE HOLDER: UNKNOWN</p> <p>14. AGENT (E.G. SOLICITOR) IF SUBMITTED ON BEHALF OF THE APPLICANT: Gamestec Leisure Ltd, Unit B12 Wira House, Ring Road, Leeds LS16 6ER Telephone: 01132589495</p> <p>15. LICENSING ACT 2003 PREMISES LICENCE REFERENCE (I.E. NUMBER)</p>	
--	--

GAMING MACHINE PERMIT APPLICATIONS FOR MORE THAN 2  
MACHINES:

CONVERSION / NEW / VARIATION / TRANSFER

(FOR USE BY PREMISES LICENSED TO SUPPLY ALCOHOL FOR CONSUMPTION ON THE  
PREMISES)

**Section E – Fee and Signature(s)**

*I enclose a cheque payable Bolton Metropolitan Borough Council ) ☒*

***I understand that I must comply with the Gaming Machine Code of Practice for Alcohol Licensed  
Premise Permits and Permissions issued by the Gambling Commission. (see guidance note 8)***

**Please note: It is an offence under section 342 of the Gambling Act 2005 if a person, without reasonable  
excuse, gives to a licensing authority for a purpose connected with that Act information which is false or  
misleading.**

Dated...14 April 2016.....

Signed (by or on behalf of Licensing Act 2003 Premises Licence holder)

.....  

**Print Name...**Roz Sage.....

\* If you wish to have more than 2 gaming machines then please check the fee payable.

**Official Use Only**

Date of receipt: .....

Name of staff member who received application form: .....

Date of receipt of fee: .....

Name of staff member who received fee: .....

Application accepted / returned (please delete as appropriate)

Date of premises licence (Licensing Act 2003) transfer (if applicable): .....

**GAMING MACHINE PERMIT APPLICATIONS FOR MORE THAN 2 MACHINES:  
CONVERSION / NEW / VARIATION / TRANSFER**

**Guidance notes:**

1. This form is to be used for the **conversion of an existing Section 34** gaming machine permit under the Gaming Act 1968, or for a **new application, variation or transfer** of a alcohol licensed premises gaming machine permit under the Gambling Act 2005.
2. The premises must be licensed under the Licensing Act 2003 to sell alcohol for consumption on the premises, without the requirement that alcohol is served only with food and there must be a bar for serving alcohol to customers on the premises.
3. The gaming machines must be located on these licensed premises.
4. A 'Premises Licence holder' is a person holding a Premises Licence under the Licensing Act 2003.
5. There is no statutory limit to the number of machines, which may be applied for although the licensing authority has some discretion in this regard.
6. The permit's duration is indefinite as it is linked to the Licensing Act 2003 Premises Licence. There is a first annual fee payable within 30 days of the date of issue of the permit and an annual fee payable after that before each anniversary of the date of issue of the permit. Failure to pay the annual fee may result in the cancellation of the permit. The annual fee is £50 (to be confirmed). There are no annual fees payable for 2 machines or less.
7. Two types of gaming machines may be located in alcohol licensed premises. These are:
  - Category C: Maximum stake = 50p / Maximum prize = £100
  - Category D: Maximum stake = 10p or 30p non-monetary / Maximum prize = £5 cash or £8 non-monetary
8. **All alcohol licensed premises which provide gaming machines for use on the premises must comply with any relevant Code of Practice issued by the Gambling Commission under Section 24 of the Gambling Act 2005.** The Gaming Machine Code of Practice for Alcohol licensed premises permits and permissions is available via the Gambling Commission's website at: <http://www.gamblingcommission.gov.uk/> Should you be unclear as to the provisions of the code of practice please contact the Gambling Commission.
9. This licensing authority must notify the applicant of its grant / refusal of the application for a permit as soon as is reasonable practicable after that decision to grant / refuse has been made.



Date:

To Whom It May Concern:

Dear Sir

RE: APPLICATION FOR GRANT OF GAMING MACHINE PERMIT (LPN AND LPGMP) - GAMBLING ACT 2005

I wish to confirm that Gamestec Leisure Limited are authorised to act as the agent of this Company, its subsidiaries, tenants and leaseholders with regard to permit applications and notifications enabling the operation of fruit machines on our various premises.

I confirm that I have been provided with a summary of the Code of Practice as laid down in the Gambling Act and understand that Premises Licence Holders are responsible for ensuring that each of site upholds this.

Yours faithfully

A handwritten signature in black ink, appearing to read "J. Lockwood", written over a dotted line.

.....Signature

J. Lockwood

.....Print

on behalf of:

Spirit Pub Company, Westgate Brewery, Bury St Edmunds, IP33 1QT

**LEGEND \***

**LEGEND:**

- [illegible]

LIMITED FLORIDA		DATE
Ship: <u>Shadock and his primary's original ship</u>		200
Special Project: <u>Ship's 100th Anniversary</u>		100
Signature: <u>Shadock</u>		50
Special License: <u>Ship's 100th Anniversary</u>		200

Revisions	Dates
-----------	-------

spirit  
club

**Barley Hall** Cordon Lane, Leeds, LS4 2LE  
T 0113 274 5577 F 0113 274 0588

**Job title** Red Lion,  
0 Salford Road, Over Hutton,  
Bolton, Lancs, BL5 1BJ.

**Company / Site** Licensing Layout

Date: 1/10/21 Time: 1:20 PM Page: 1 of 1	Drawing No. <b>M6720</b>
--	-----------------------------

All kitchen steps to raised areas will comply with The Building Regulations applicable at the time of construction, with a maximum rise of 150mm.

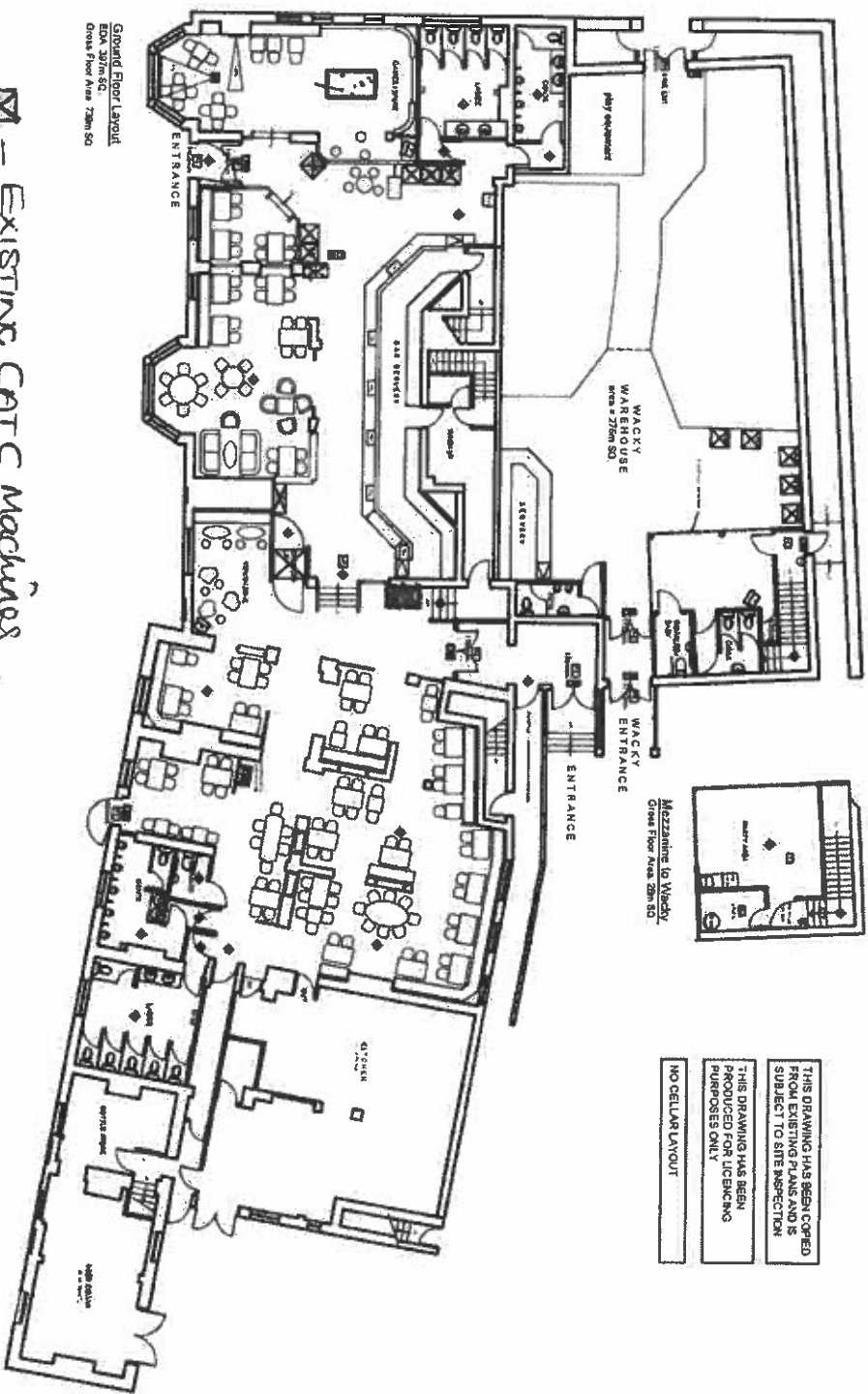

- ☒ - Existing CHC Machines
- ☒ - DUL3 machines
- ☒ - CHD CRANES APPLIED FOR

Ground Floor Layout  
EDA 397m S.C.  
Gross Floor Area 739m Sq

## List of premises and number of machines

Premises Name	Address	Address2	Town	Postcode	Number of machines
BRIDGE INN	121 Church Street	Horwich	Bolton	BL6 7BR	3
SOUTHFIELDS	Great Lever		Bolton	BL3 2EE	4
BEE HIVE	991 Chorley New Road	Lostock	Bolton	BL6 4BA	6
HOLLYWOOD BOWL	25-27 The Linkway	Horwich	Bolton	BL6 6JA	36
THREE PIGEONS	820 Wigan Road		Bolton	BL3 4RD	4
REFLEX @ THE ELEPHANT & CASTLE	4-10 Deansgate	Bolton		BL1 1BR	6
SPINNING MULE	Nelson Square	Bolton		BL1 1JT	4
J2 AND THE ATTIC	23-25 Mawdsley Street	Bolton		BL1 1LL	3
COTTON KIER	2-4 Eagley Brook Way	Bolton		BL1 8TS	3
YATES'S WINE LODGE	36 Bradshawgate	Bolton		BL1 1DG	6
BEAUMONT ARMS	Armadale Road	Bolton		BL3 4XB	3
DOFFCOCKER INN	780 Chorley Old Road	Bolton		BL1 5QE	3
BOWLING GREEN	175 Lee Lane	Horwich	Bolton	BL6 7JD	3
CROWN HOTEL	1 Chorley New Road	Horwich	Bolton	BL6 7QJ	3
ROBERT SHAW	53 Market Street	Westhoughton	Bolton	BL5 3AG	6
STARKIE ARMS	150 Tonge Moor Road	Bolton		BL2 2HT	3
WELCOME INN	72 Market Street	Farnworth	Bolton	BL4 7NY	3
DG BAR	109-111 Bradshawgate	Bolton		BL1 1QD	4
BLUE BOAR	96 Deansgate	Bolton		BL1 1BD	4
RED LION	1-3 Salford Road	Bolton		BL5 1BJ	4
DRAGONFLY	60-62 Bradshawgate	Bolton		BL1 1DP	3
CAPITOL	37-41 Churchgate	Bolton		BL1 1HU	4
HORWICH PARK INN	1 Arena Approach	Horwich	Bolton	BL6 6LB	3